

WETHERSFIELD MANOR HOUSE.

LOT 1.

G L E B E  
L A N D S

J O H N C U T T S E S Q R E

Property of the late  
T. G. G. WHITE, ESQ.  
Property of the late  
D R B L U N D E L L

BROOK FARM

P A R K

THE MANOR HOUSE

P A R K

ICE HOUSE

The Lake

P A R K

PROPERTY OF THE LATE THOMAS GEORGE GRAHAM WHITE, ESQ.

Scale of Chains

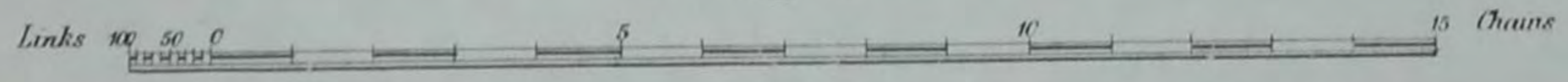

To the Village

from Braintree

THE WETHERSFIELD MANOR HOUSE ESTATE.

LOT 2.



Scale of Chains

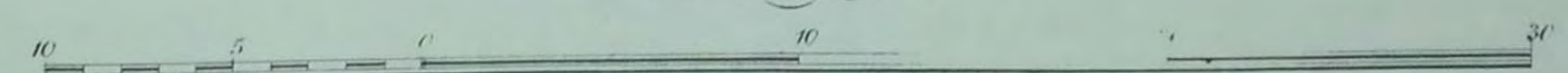

# AND PARK WOOD,

## WETHERSFIELD.

as follows:—

### SCHEDULE.

	Cultivation.	Quantity.
	A. R. P.	A. R. P.
...	Wood	52 0 31
...	Arable	25 2 24
...	Ditto	14 0 11
...	Ditto	15 3 12
...	Ditto	15 1 15
...	—	1 0 0
...	—	0 0 16
...	Arable	16 0 8
...	Ditto	17 8 25
...	TOTAL	158 0 22

TOTAL OF

r. 22 p.

ARABLE, at present in the occupation of Mr. Matthew ... 1879, and the remainder is WOOD LAND in ...

Cottage and 16 rods of Ground, which is Copyhold Fine ... Wethersfield. Quit Rent 2d.

ate near the Village of Wethersfield,

RRANGED BLOCK OF BUILDINGS,

and Concreted Bays, Stable for Draught Horses, Enclosed Stock Yards, &c.; there is

ED COTTAGE WITH GARDEN,

tion of the Stockman, and

with Bakehouse, Garden, &c.,

of a Labourer.

Lichfield toward the East, on Property of Miss Gent  
Representatives of the late Dr. Blundell toward the  
ethersfield to Hedingham on the South.

on the Keeper's Cottage and 16 rods.

	£	s.	d.
TUTORS	150	0	0
IN HAND	32	10	0
THE TENANT, ESTIMATED	12	10	0
	4	0	0
	<u>£199</u>	0	0

## THE WETHERSFIELD MANOR HOUSE ESTATE.

### LOTS 9. 10. 11. 12. 13. & 14.

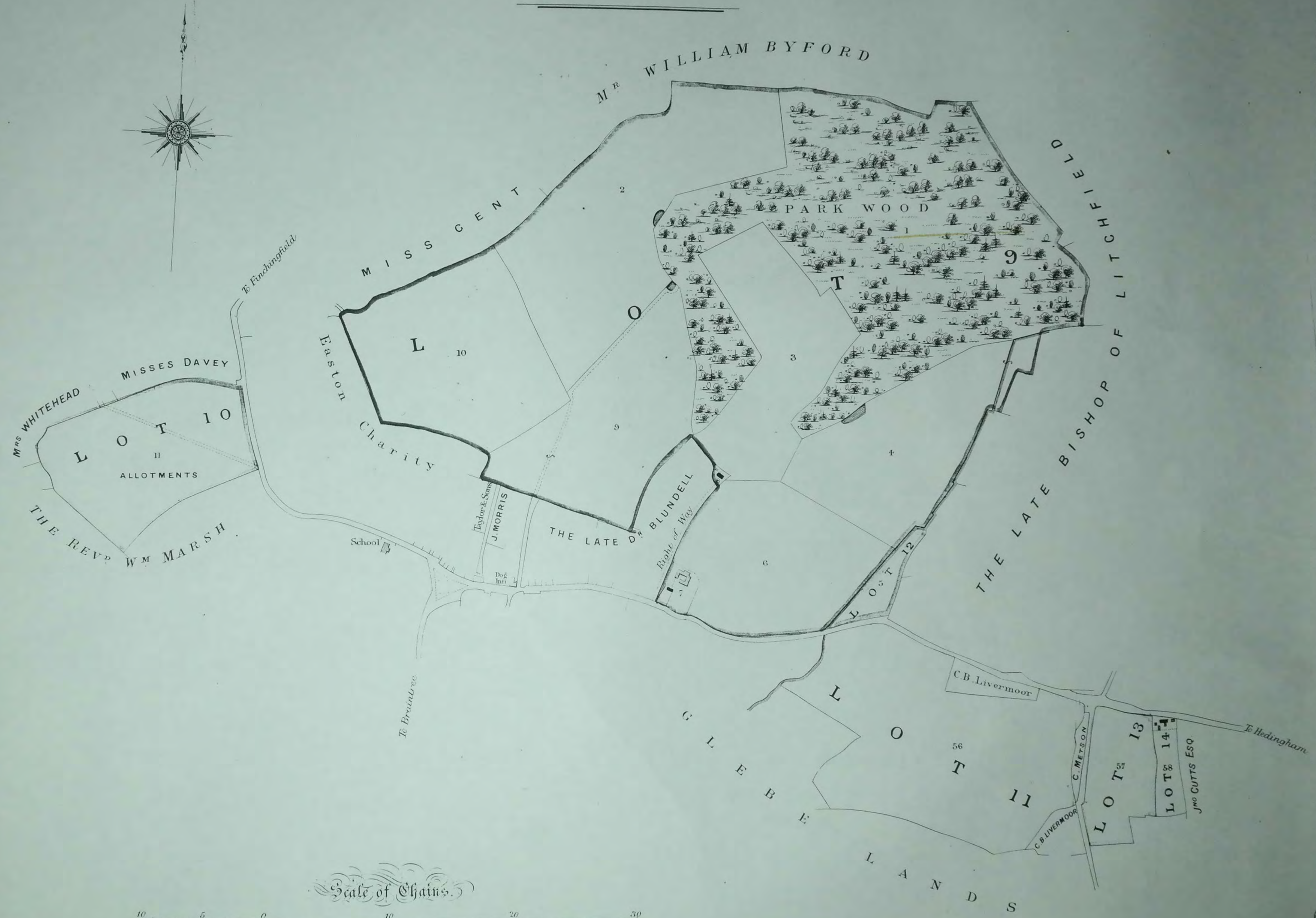

Scale of Chains.

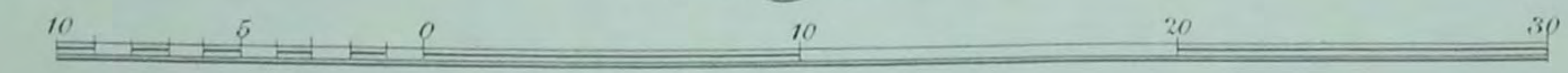

THE WETHERSFIELD MANOR HOUSE ESTATE.

LOT 25.


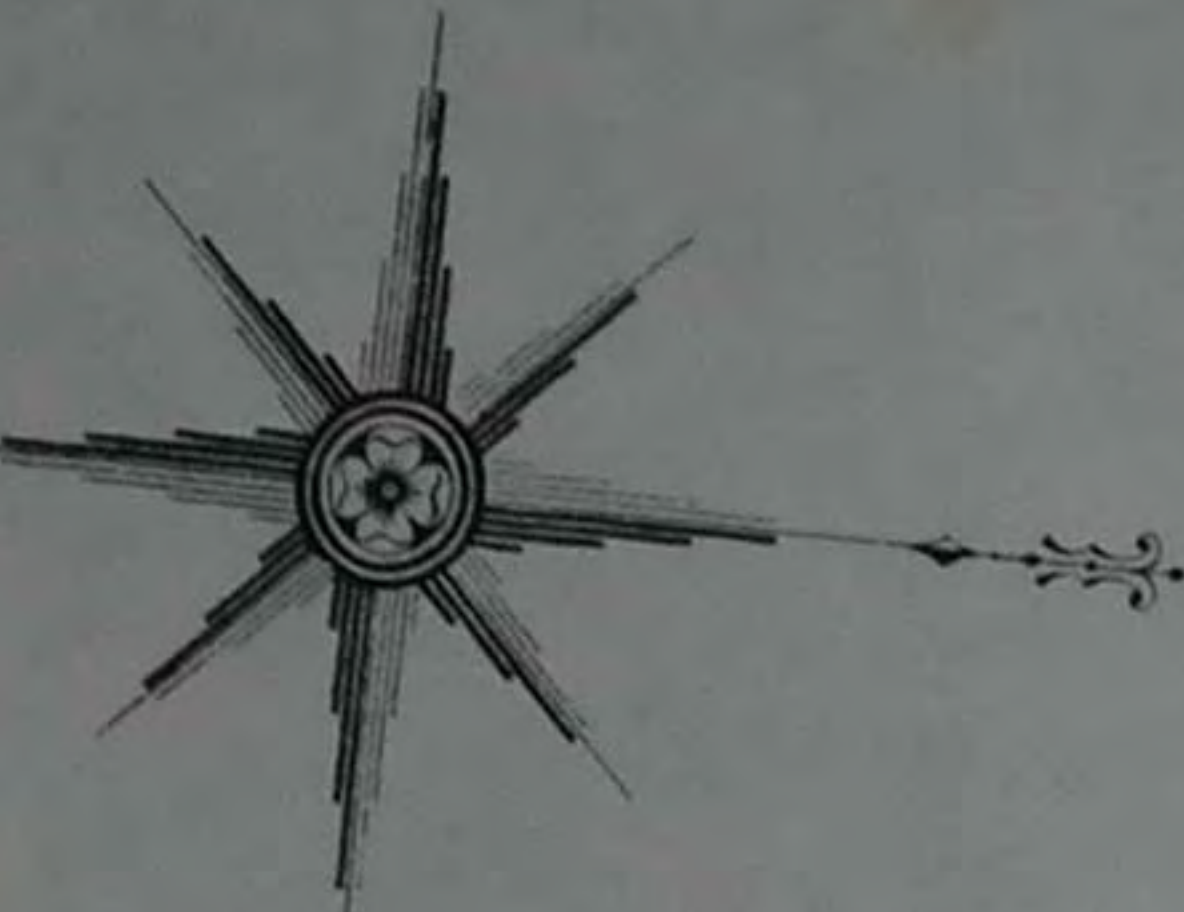

Scale of Chains

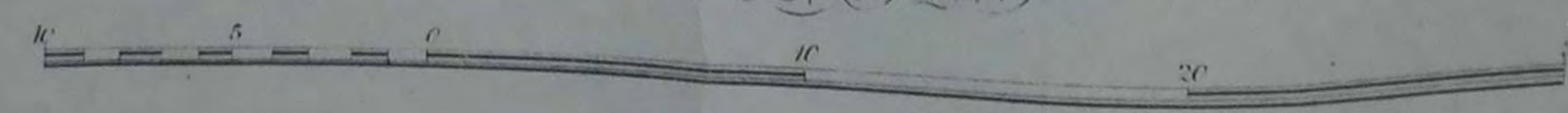

THE WETHERSFIELD MANOR HOUSE ESTATE.

LOTS 26 & 27.

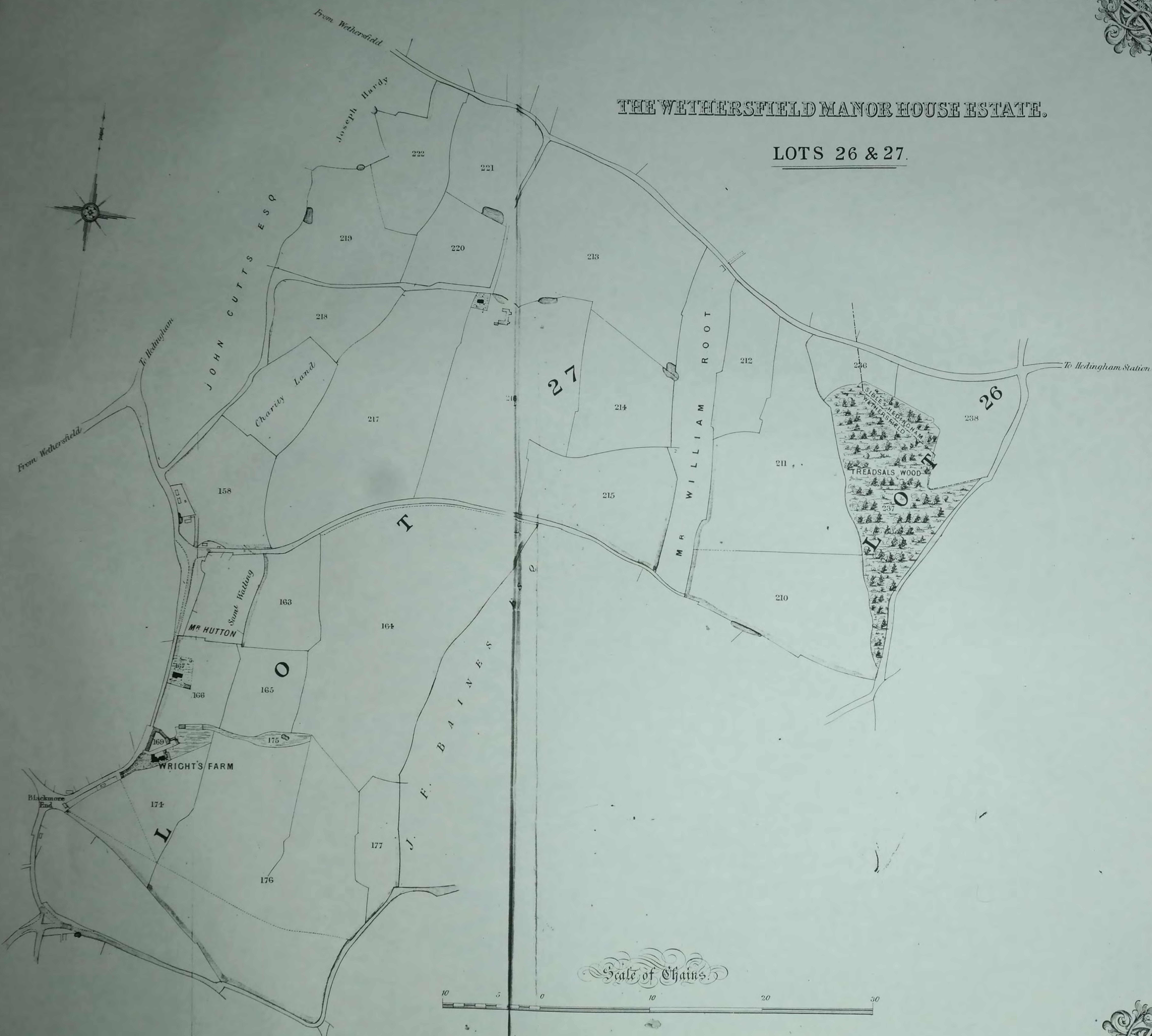

EXCELLENT  
**WRIGHT**  
IN THE

No. on Estate Plan.	
158	Bar
163	Hc
164	Bl
165	Til
166	Hc
167	Hc
169	W
174	Hc
175	Cha
176	Gar
177	Loc
210	Cl
211	W
212	Dit
213	Dit
214	Sev
215	Par
216	Bar
217	Tom
218	Woc
219	Bl
220	Dit
221	Tar
222	Litt

**26**

EXCELLENT FARM

Pleasantly situated  
And containing Good Dry Cellar

And include Dairy, Brew-house, Wash-house  
&c., and the Premises are

THE  
Are well placed and conveniently  
Floors, Range of Stables for Draught

The Park Barn Premises  
And include a convenient Cottage for Labourers

The Farm is bounded and intersected  
of — Hayward, Esq., J. Cutts, Esq.,  
in the occupation, with other Land

Apportioned Rent ...  
No. 212 is now held with other  
be given at Michaelmas: A

Of this Lot 7A. 3R. 24P. is Copyhold of  
mainder is F

